



TUROSMTART Wi-Fi A19 LED



Features & Benefits



Color Changing



Tunable White



Light Dimmable

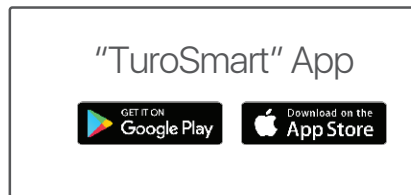

- Smart Control** Use TuroSmart app to control your light from anywhere you have internet access.
- Easy Dimming** No need to install a dimmer, our WiFi A19 LED easily dims to the desired light level.
- Tunable White** Independent from dimming, choose your white from 2700K to 5000K.
- Color Change** Tap on any light color from our full spectrum wheel to match your specific mood.
- Set a Schedule** Have your lights come on or off when you want.
- Use Your Voice** Activate using Amazon Alexa or Google Assistant.

2-year limited warranty

Temperature range between -40°C and +45°C

Dimensional drawing

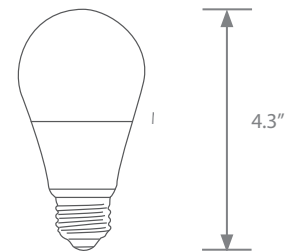

Product Specification

Model Number	Watts	Replacement Incandescent	Base	Voltage (V)	Hour Rating	Beam Angle	Initial Lumens(lm)	CCT(K)	CRI	Damp LOC.	M.O.L. (inch)
SV-A19/10W/WIFI/D	10	60W	E26	120	15,000	220°	800	2700-5000	80	Y	4.3

Using Guide

1. Download APP "TuroSmart" in "Apple Store" or "Google Play".
2. Install WiFi LED bulb in the fixture/ socket.
3. Switch on and off the bulb repeatedly until the bulb blinks, normally after 3 or 4 times. After the bulb blinks, it will enter the networking connection mode just in a few seconds.
4. Make your phone wifi connected, then open the APP "TuroSmart" and follow "Setup Guide" to set your smart lamp.

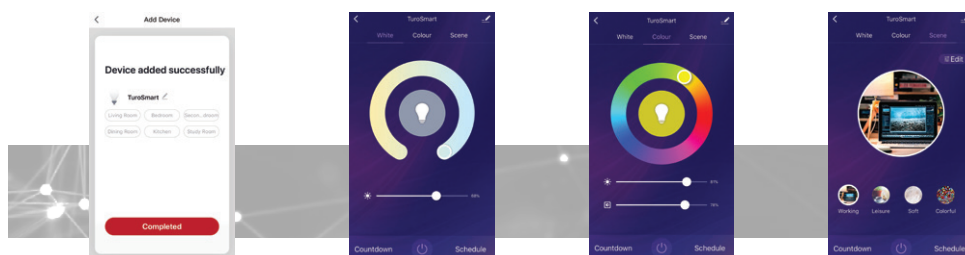

Wi-Fi Bulb Setup Guide

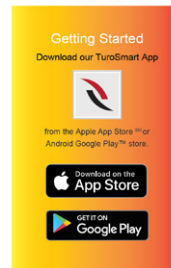

Bulb Setup Guide

