

# LED FIXTURE

## DL Series

### LED Eco-Commercial Strip DL-EC NEW MW-MK

Linear 4' and 8' LED strip light, 120-347V auto-sensing driver  
Multiple Wattage - Multiple Kelvin

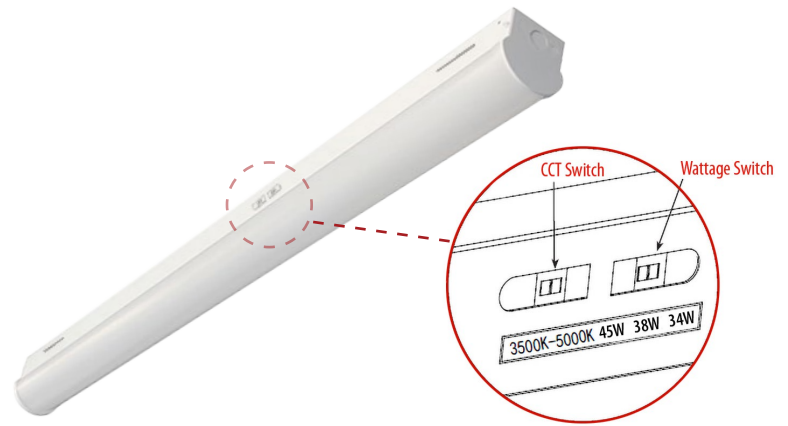

#### Features & Benefits

- cUL listed, DLC(Premium)
- Selectable wattage and adjustable CCT
- 4' and 8' length selection
- 120-347V Auto-sensing driver, 0-10V dimming
- Average rated life 100,000 hrs L70 (TM-21 @ 70 °C), CRI ≥ 80
- White metal finish, PMMA Opal Lens
- Surface or Suspended mounting, row mountable w/ joiner plate
- Damp location rated
- Operating temperature range between -20°C and +50°C

#### Dimensional Drawing

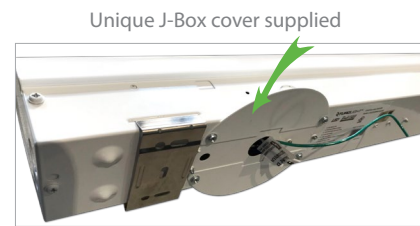
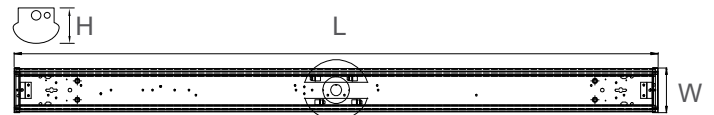

Unique J-Box cover supplied

	L	W	H
4FT	47.3"	3.3"	3.6"
8FT	94.2"	3.3"	3.6"

#### Warranty

5-year limited warranty in commercial use from the date of purchase

#### Applications

Offices, Hallways, Multipurpose Rooms, Warehouse etc.

#### Ordering Information Example: DL-EC/4F/56W/MK/120-347V/D

Family Name	Fixture Type	Size	Wattage	CCT	Voltage	Dimmable	Sensor	Option
DL (Deltalum)	EC (Eco-Commercial)	4F (4') 4FS (4' Small Wattage) 4FL (4' Large Wattage) 8FL (8' Large Wattage)	56W MW (Multiple Wattage)	MK (Multiple CCT)	120-347V	D (Dimmable)	S (Sensor)	RM (Row MTG Plate) S (Microwave Sensor) TL-2052 PIR Sensor DL-EC/MS/CONTROLLER

#### Product Specification

Ordering Code	DLC (Premium)	Model Number	Wattage (W)	Input Voltage (V)	Hour Rating (L70)	Beam Angle	Initial Delivered Lumens (lumen)	CCT (K)	CRI	Damp Location	M.O.L (inch)	Case QTY.
3666309	Y	DL-EC/4F/56W/MK/120-347V/D	56	120-347V	100,000	120°	7448	35-40-50	>80	Yes	48	6
3664306	Y	DL-EC/4FS/MW/MK/120-347V/D	30-25-18	120-347V	100,000	120°	4050-3250-2340	35-40-50	>80	Yes	48	6
3664307	Y	DL-EC/4FL/MW/MK/120-347V/D	45-38-34	120-347V	100,000	120°	6075-4940-4420	35-40-50	>80	Yes	48	6
3664308	Y	DL-EC/8FL/MW/MK/120-347V/D	90-75-65	120-347V	100,000	120°	12150-9750-8450	35-40-50	>80	Yes	96	4
3666310	Y	DL-EC/4F/56W/MK/120-347V/D/S	56	120-347V	100,000	120°	7448	35-40-50	>80	Yes	48	6
3680307	Y	DL-EC/4FS/MW/MK/120-347V/D/S	30-25-18	120-347V	100,000	120°	3900-3250-2340	35-40-50	>80	Yes	48	6
3666311	Y	DL-EC/4FL/MW/MK/120-347V/D/S	45-38-34	120-347V	100,000	120°	6075-4940-4420	35-40-50	>80	Yes	48	6
3666312	Y	DL-EC/8FL/MW/MK/120-347V/D/S	90-75-65	120-347V	100,000	120°	12150-9750-8450	35-40-50	>80	Yes	96	4
3660057		DL-EC/4F/LENS	4ft, replacement white PMMA lens									
3660058		DL-EC/8F/LENS	8ft, replacement white PMMA lens									
3660092		DL-EC/4F/WG	4ft, Wire guard									
3660096		DL-EC/RM	Row mounting plate									
		S	Microwave sensor factory installed (consult for lead time)									
3768101		TL-2052	PIR motion sensor (sold separately)									
3660097		DL-EC/MS/CONTROLLER	Hand Held Remote Control for Micro-Sensor									

# LED Eco-Commercial Strip

## DL-EC NEW MW-MK

### Microwave Motion Sensor



Microwave Motion Sensor factory installed

Detection Area	100%/75%/50%/25% (Remote Control: 100%/75%/50%/25%)
Hold time	8S/30S/1min/5min/10min/15min/30min (Remote Control: 8S/1min/5min/15min/30min)
Stand-by Period	0S/1min/3min/5min/10min/30min/+∞ (Remote Control: 0S/1min/5min/30min/+∞)
Daylight Sensor	5lux/15Lux/30Lux/50Lux/100lux/150lux/Disable (Remote Control: 5lux/15Lux/50Lux/150lux/Disable)
Stand-by Dim Level	10%/20%/30%/40% (Remote Control: 10%/20%/30%/40%/50%)
Detection Distance	12m*8m (Max.)

The sensor can support the infrared remote control



DL-EC/MS/CONTROLLER

### Sensor Settings

Detection Area	1	2
100%	ON	ON
75%	ON	-
50%	-	ON
25%	-	-

Hold Time	3	4	5
8S	ON	ON	ON
30S	ON	-	ON
1min	-	ON	ON
5min	ON	-	-
10min	-	ON	-
15min	-	-	ON
30min	-	-	-

Stand-by Period	6	7	8
0S	ON	ON	ON
1min	ON	-	ON
3min	-	ON	ON
5min	ON	-	-
10min	-	ON	-
30min	-	-	ON
+∞	-	-	-

Stand-by Dim Level	1	2
10%	ON	ON
20%	ON	-
30%	-	ON
40%	-	-

Daylight Sensor	3	4	5	6
5Lux	ON	ON	ON	ON
15Lux	-	ON	ON	ON
30Lux	ON	-	ON	ON
50lux	-	-	ON	ON
100lux	ON	ON	-	ON
150lux	ON	ON	ON	-
Disable	-	-	-	-