

Installation Guide

VIVID™ T8 LED Direct Fit Shatterproof 4 Tube (DFSP4)

Please read this installation manual carefully, it contains important information and notes regarding the installation and operation of VIVID™ T8 LED Direct Fit Tube (DFSP4).

Applicable to the following models

Order Code	Model Number	DLC	Description	Tube Size	Volts*
1762785	VIV-T8DFSP4/9W/30/F	-	T8 Direct Fit 2ft 9W G13 30K Frost Shatterproof	24"	120-277,347
1762364	VIV-T8DFSP4/9W/35/F	-	T8 Direct Fit 2ft 9W G13 35K Frost Shatterproof	24"	120-277,347
1762867	VIV-T8DFSP4/9W/40/F	✓	T8 Direct Fit 2ft 9W G13 40K Frost Shatterproof	24"	120-277,347
1762543	VIV-T8DFSP4/9W/50/F	✓	T8 Direct Fit 2ft 9W G13 50K Frost Shatterproof	24"	120-277,347
1762735	VIV-T8DFSP4/13W/30/F	✓	T8 Direct Fit 4ft 13W G13 30K Frost Shatterproof	48"	120-277,347
1762339	VIV-T8DFSP4/13W/35/F	✓	T8 Direct Fit 4ft 13W G13 35K Frost Shatterproof	48"	120-277,347
1762822	VIV-T8DFSP4/13W/40/F	✓	T8 Direct Fit 4ft 13W G13 40K Frost Shatterproof	48"	120-277,347
1762524	VIV-T8DFSP4/13W/50/F	✓	T8 Direct Fit 4ft 13W G13 50K Frost Shatterproof	48"	120-277,347
1763234	VIV-T8DFSP4/17W/30/F	✓	T8 Direct Fit 4ft 17W G13 30K Frost Shatterproof	48"	120-277,347
1763315	VIV-T8DFSP4/17W/35/F	✓	T8 Direct Fit 4ft 17W G13 35K Frost Shatterproof	48"	120-277,347
1763436	VIV-T8DFSP4/17W/40/F	✓	T8 Direct Fit 4ft 17W G13 40K Frost Shatterproof	48"	120-277,347
1763515	VIV-T8DFSP4/17W/50/F	✓	T8 Direct Fit 4ft 17W G13 50K Frost Shatterproof	48"	120-277,347

*Ballast dependant

- Please keep this Quick Installation Guide for future reference.
- Operates on instant start ballasts only.
- This lamp is non-dimmable.
- Modifications to the product void the warranty.
- Use in splash zones of food equipment.

INSTRUCTIONS

- Switch-off power to the luminaire.
- Remove diffuser (if provided).
- Remove the existing fluorescent lamps from the luminaire.
- Install the VIVID™ T8 LED Direct Fit replacement lamp (one for each fluorescent lamp removed).
- Replace diffuser (if removed in step 2).
- Switch on power to the luminaire.

CAUTION

- FIXTURE HOLDER MUST BE LESS THAN TWO YEARS OLD.
- IF THE LAMP OR LUMINAIRE EXHIBITS UNDESIRABLE OPERATION (BUZZING, FLICKERING, ETC.), IMMEDIATELY TURN OFF POWER, REMOVE LAMP FROM LUMINAIRE AND CONTACT THE MANUFACTURER.
- RISK OF FIRE. DO NOT INSTALL IN A PRE-HEAT LUMINAIRE.

THESE DEVICES ARE NOT INTENDED FOR USE WITH EMERGENCY EXIT FIXTURES OR EMERGENCY EXIT LIGHTS. THIS LAMP ONLY OPERATES ON ELECTRONIC BALLASTS. IF LAMP DOES NOT LIGHT WHEN THE LUMINAIRE IS ENERGIZED, REMOVE LAMP FROM LUMINAIRE AND CONTACT LAMP MANUFACTURER OR QUALIFIED ELECTRICIAN

Lamps must be operated within an ambient fixture temperature of -22F (-30c) and 113F (45c) to ensure UL compliance.



1

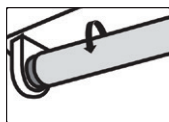

2 Fluorescent

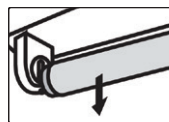

3 Fluorescent

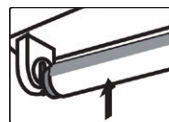

4 VIVID™ T8 LED Direct Fit Replacement lamp

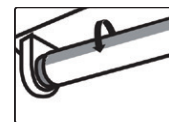

5 VIVID™ T8 LED Direct Fit Replacement lamp



6

THE RETROFIT ASSEMBLY IS ACCEPTED AS A COMPONENT OF A FLUORESCENT LUMINAIRE WHERE THE SUITABILITY OF THE COMBINATION SHALL BE DETERMINED BY CSA OR AUTHORITIES HAVING JURISDICTION.



Conforms to NSF/ANSI 2



TO ORDER PLEASE CALL 1-877-736-0447 OR EMAIL: SALES@TUROLIGHT.COM

Tel: (416) 736-0447 • Toll Free: 1 (877) 736-0447 • Fax: (416) 736-4890 • Email: info@turolight.com • Website: www.turolight.com